

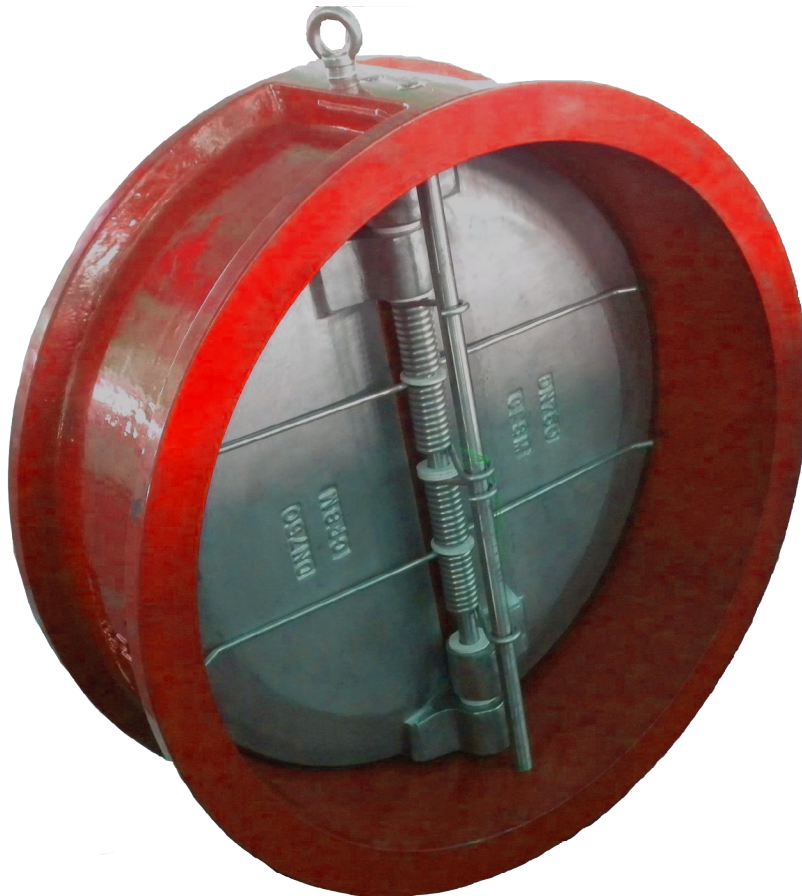

**SERIES CVIII
AWWA C518
DOUBLE DISC CHECK VALVES
2"-48"**



Series CVIII

Double Disc Check Valves to AWWA C518

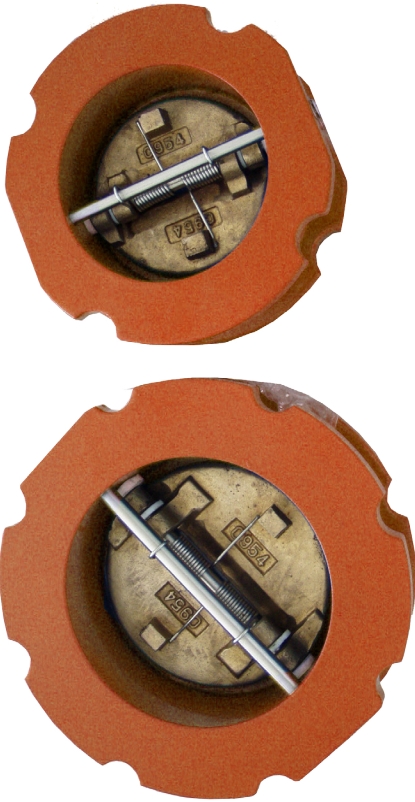

Standards:

- AWWA C518

Sizes:

- 2in (DN50) - 48in (DN1,200)

Pressure Ratings (water):

- 200 psi to 300 psi*

Fluid Velocity:

- 16 ft/sec maximum

Laying Lengths:

- AWWA C518

Connection Options*:

- ANSI/ASME B16.1 Class 125
 - Wafered
 - Threaded Lug

*Other options available upon request

- The VSI Series AWWA C518 Double-Disc Check Valves are designed for today's modern water and treatment plants. Our valves meet or exceed the current AWWA C518 Standard.
- The Series AWWA C518 Double-Disc Check Valve line has completed the AWWA Proof of Design tests, and every valve is tested at the factory.
- VSI has NSF 61 Coatings available, as well as, several AWWA C550 certified coating options.
- VSI offers several body materials ranging from Cast Iron to Cast Stainless Steel. We specialize in custom crafted valves.
- All springs, hinge pins, stop pins and plugs are all made from 316 Stainless Steel.
- Our standard EPDM seat is vulcanized to a machined and sandblasted body surface for a superior bonding. All of our seats have a raised bead for maximum sealing with low pressure applications, and our discs all extend beyond the seating material to prevent uneven wearing.
- Our standard EPDM seat provides maximum temperature ratings up to 250°F. With our option of Viton™ or High Temp Viton™ seating material, our temperature ratings can reach up to 400°F.

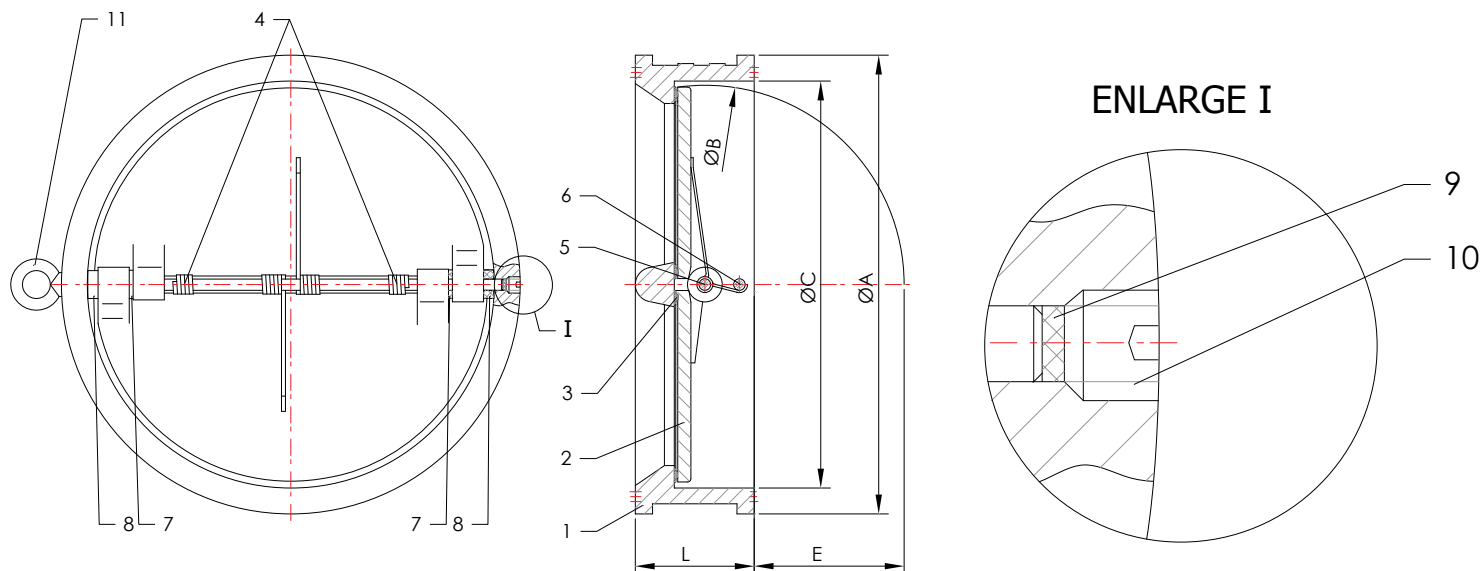

DIMENSIONS

SIZE	2" (50)	2.5" (65)	3" (75)	4" (100)	5" (125)	6" (150)	8" (200)	10" (250)	12" (300)	14" (350)	16" (400)	18" (450)	20" (500)	24" (600)
ØA	4.125	4.875	5.375	6.875	7.750	8.750	11.000	14.563	16.125	17.688	20.250	21.625	23.813	28.250
ØB	2.063	2.500	3.063	4.000	5.000	6.063	8.000	10.000	11.938	14.500	16.000	18.063	19.750	23.750
ØC	2.563	3.063	3.688	4.625	5.688	6.750	8.750	10.875	10.875	14.813	16.375	18.375	20.250	24.250
L	2.125	2.125	2.250	2.500	2.750	3.000	3.750	4.250	5.625	7.250	7.500	8.000	8.375	8.750
E	0.063	0.250	0.563	0.938	1.250	1.750	2.375	3.250	3.438	3.688	4.438	5.188	5.813	7.625

PAGE 3

PARTS AND MATERIAL LIST

NO.	Part	Standard Material	Optional Material
1	Body	Cast Iron	Ductile Iron, Stainless Steel
2	Disc	Stainless Steel	Bronze, Aluminum Bronze
3	Seat	EPDM	Viton™, High Temp. Viton™
4	Spring	Stainless Steel 316	
5	Disc Shaft	Stainless Steel 316	
6	Stopper Shaft	Stainless Steel 316	
7	Disc Bushing	PTFE	Nylon, Stainless Steel
8	Body Bushing	PTFE	Nylon, Stainless Steel
9	Stem Seat	EPDM	
10	Shaft Screw	Stainless Steel 316	
11	Lifting Eye	Stainless Steel	

VSI Waterworks LLC

tel: 1 (770) 740 0800

fax: 1 (770) 740 8777

email: sales@vsiwaterworks.com



www.VSIWaterworks.com

As part of a process of on-going product development, VSI reserves the right to amend or change specifications without prior notice. Published data may be subject to change. For the latest version, visit our website at www.vsiwaterworks.com