

A Direction (Square)

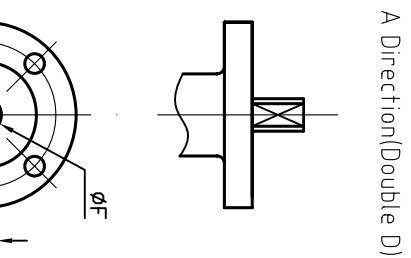
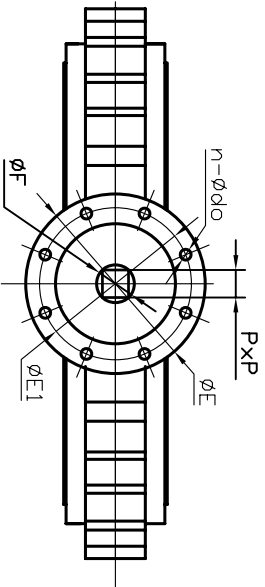

A Direction (Double D)

Nominal pressure	100PSI
Test Strength test pressure	1.5Mpa
Sealing test pressure	1.1Mpa
Maximum working temperature	-10℃ to +90℃
Suitable Media	W.O.G etc

- 1.Design and manufacture according to API 609.
- 2.Face to face according to API609.
- 3.Flange drilling according to ANSI125/150.
- 4.Top flange drilling according to ISO 5211.
- 5.Pressure test according to API598.

Size	L	$\phi D1$	n-M	H1	H2	H3	Flange No	ϕE	$\phi E1$	h	n- ϕd_0	ϕF	P
DN700	165	863.6	28-1 1/4	623.9	505.1	66	F25	300	254	5.5	8-18	60.2	46
DN750	165	914.4	28-1 1/4	646	499	66	F25	300	254	5.5	8-18	60.2	46
DN800	190	977.9	28-1 1/2	672	576	66	F25	300	254	5.5	8-18	60.2	46

Item	Part name	Material	Qty	Remark
7	Pin	SS316	2	
6	Seat	EPDM	1	
5	Disc	SS304	1	
4	Stem	SS416	1	
3	O Ring	EPDM	2	
2	Bushing	PTFE	5	
1	Body	Ductile iron	1	

DRN	Wang	WEIGHT	MATERIAL
CHK		SCALE	Butterfly Valve

APP	DATE	REV	2012-06
	06/04/2012		

WATERWORKS

B10L-YX

REV 2012-06