

mm/ inches	H1	H2	H3	L	ØC	n-M	ISO	ØN	ØC1	n1	Ød1	ØF	□H
350 14"	267 10.512	368 14.488	45 1.772	78 3.071	476.2 18.748	12 - 1	F10	125 4.921	102 4.016	4	12 0.472	28.2 1.11	22 0.866
400 16"	297 11.693	400 15.748	51.2 2.016	102 4.016	539.7 21.248	16 - 1	F14	175 6.89	140 5.512	4	18 0.709	28.2 1.11	22 0.866
450 18"	318 12.52	422 16.614	51.2 2.016	114 4.488	577.8 22.748	16 - 1 1/8	F14	175 6.89	140 5.512	4	18 0.709	36.2 1.425	27 1.063
500 20"	348 13.701	480 18.898	64.2 2.528	127 5.000	635 25.00	20 - 1 1/8	F14	175 6.89	140 5.512	4	18 0.709	36.2 1.425	27 1.063
600 24"	444 17.48	562 22.126	70.2 2.764	154 6.063	749.3 29.50	20 - 1 1/4	F16	210 8.26	165 6.496	4	22 0.866	48.2 1.898	36 1.417
700 28"	505 19.89	623 24.528	66 2.598	165 6.496	863.6 34.00	28 - 1 1/4	F25	300 11.81	254 10.000	8	18 0.709	60.2 2.370	46 1.811
750 30"	499 19.65	646 25.433	66 2.598	166 6.535	914.4 36.00	28 - 1 1/4	F25	300 11.81	254 10.000	8	18 0.709	60.2 2.370	46 1.811
800 32"	576 22.68	672 26.457	66 2.598	190 7.480	977.9 38.5	28 - 1 1/2	F25	300 11.81	254 10.000	8	18 0.709	60.2 2.370	46 1.811

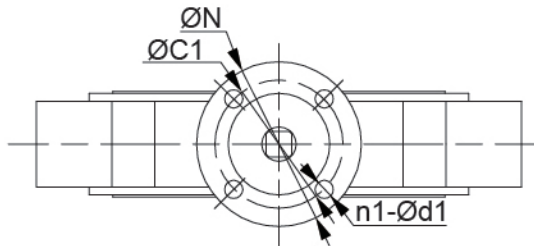
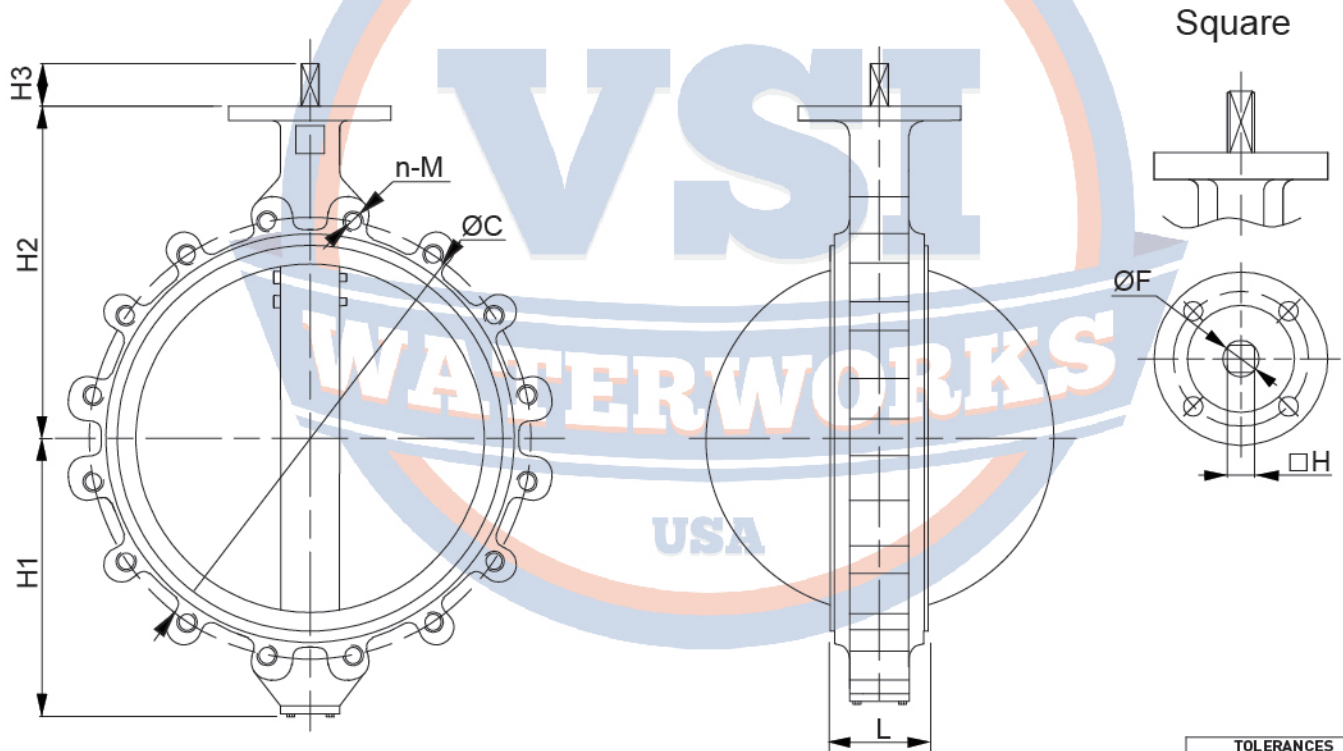

TOLERANCES	
DECIMAL	ANGULAR
X.X	±0.1 ±0.25°
X.XX	±0.02
X.XXX	±0.008

NOTES:

- 1) LUGS PER ASME/ANSI B16.1 CL125 AND B16.5 CL150
- 2) ACTUATOR MOUNT PER ISO 5211
- 3) VALVE MANUFACTURED & TESTED IN ACCORDANCE WITH API 609 AND API 598
- 4) SEAL PRESSURE 200PSI
- 5) HYDROSTATIC TEST PRESSURE 300PSI

VSI WATERWORKS 1155 ALPA DR. ALPHARETTA, GA	
14"-32" LUGGED SERIES 2100 INDUSTRIAL BUTTERFLY VALVE	
UNITS: INCHES	REV 0
SCALE: NTS	08-29-13
DWG. NO. S2100-0025	