

VALVE IS LEFT TURN (COUNTER-CLOCKWISE) TO OPEN			
DESIGN:	AWWA C504	CONNECTION:	ASME B16.5 CLASS 150
TESTING:	AWWA C504	FACE TO FACE:	ASME B16.10
INSIDE COATING:	AWWA C550	OUTSIDE COATING:	AWWA C550
TECHNICAL SUMMARY			
WORKING PRESSURE:	150 psi		
MAX SEAT TEMP:	225° F		
COATINGS MEET AWWA C550			

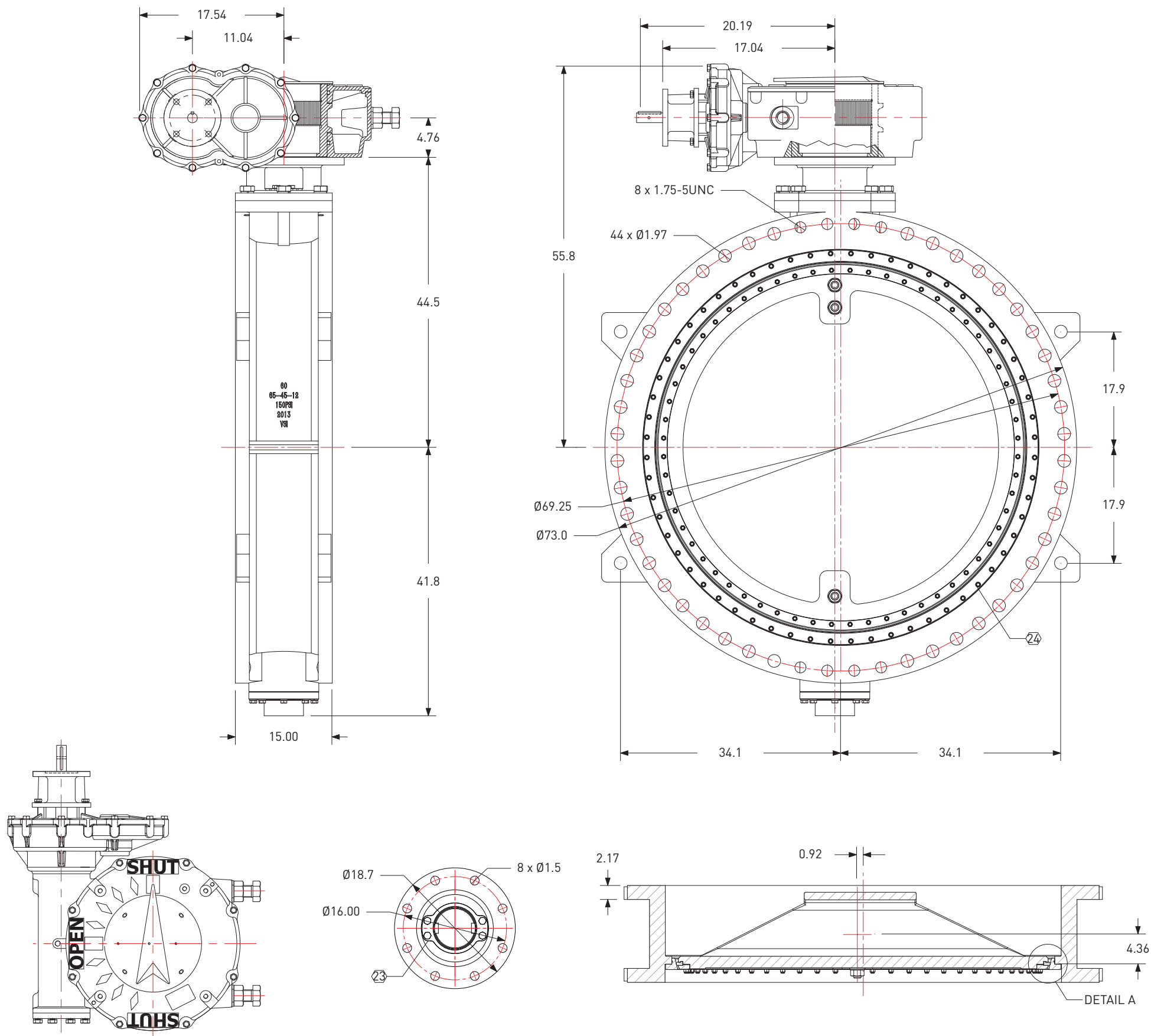

NO	NAME	MATERIAL	COUNT
1	UPPER STEM	ASTM A276 316	1
2	BONNET	ASTM A536 65-45-12	1
3	PACKING GLAND	ASTM A536 65-45-12	1
4	PACKING SET	EPDM	1
5	BUSHING	RPTFE	2
6	BODY	ASTM A536 65-45-12	1
7	SEAT RING	ASTM A276 316	1
8	SEAL	EPDM	1
9	SEAL RETAINING RING	ASTM A276 316	1
10	TAPER PIN	ASTM A276 316	3
11	HEX NUT	ASTM A276 316	3
12	STUD	ASTM F593 GROUP 2	60
13	NYLON LOCK-NUT	ASTM F593 GROUP 2	60
14	DISC	ASTM A536 65-45-12	1
15	O-RING	EPDM	1
16	LOWER STEM	ASTM A276 316	1
17	THRUST BUSHING	ASTM B584	1
18	O-RING	EPDM	1
19	LOWER COVER	ASTM A536 65-45-12	1
20	SPLIT LOCK WASHER	ASTM A276 316	8
21	HEX BOLT	ASTM F593 GROUP 2	8
22	HEX BOLT	ASTM F593 GROUP 2	6
23	HEX BOLT	ASTM F593 GROUP 2	4
24	HEX SOCKET BOLT	ASTM F593 GROUP 2	60
25	CENTERING BOLT	ASTM B584	1
26	HEX SOCKET BOLT	ASTM F593 GROUP 2	4
27	SEALING WASHER	PTFE	1
28	LOCK NUT	ASTM A276 316	1
29	SEAL	EPDM	1
30	PROTECTIVE COVER	ASTM A36	1

PROJECT

TITLE 60-INCH DOUBLE OFFSET REPLACEABLE SEAT BUTTERFLY VALVE WITH VSI SERIES D WORM GEAR

DRAWING NUM. BFIII-60-DIDI-316316-D509WG1088M-121312

	SCALE	NTS	A3
	UNITS	INCHES	
	SHEET	1 OF 2	
DO NOT SCALE			

TOLERANCES		
DECIMAL		ANGULAR
.X	± .1	± .25°
.XX	± .01	
.XXX	± .005	

	NAME	SIGNATURE	DATE	NOTE
DRAWN	JBH		12/12	
CHK'D	CJK	<i>[Signature]</i>	12/12	
REVISED	CJK		04/13	CHANGE TO VSI GEAR, ADD CENTERING BOLT

Valve Solutions, Inc.

VALVE IS LEFT TURN (COUNTER-CLOCKWISE) TO OPEN		TECHNICAL SUMMARY	
DESIGN: AWWA C504	CONNECTION: ASME B16.5 CLASS 150	WORKING PRESSURE: 150 psi	
TESTING: AWWA C504	FACE TO FACE: ASME B16.10	MAX SEAT TEMP: 225° F	
INSIDE COATING: AWWA C550	OUTSIDE COATING: AWWA C550	COATINGS MEET AWWA C550	

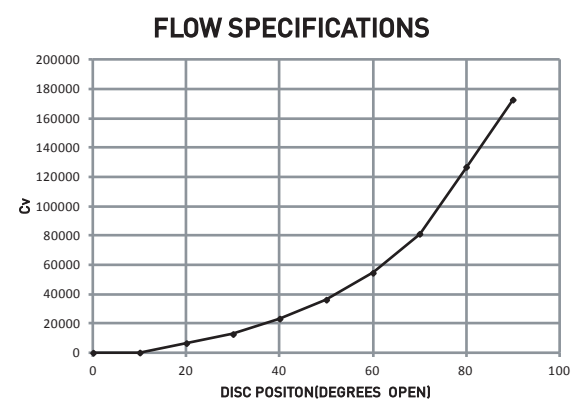
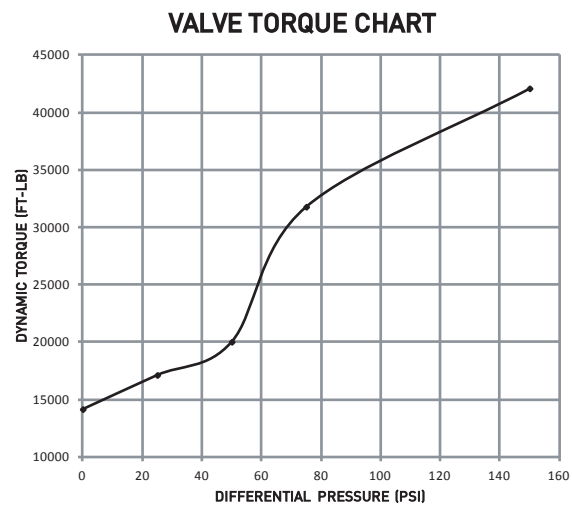

WORM GEAR DATA

MAX OUTPUT TORQUE (FT-LB)	RATIO	MECHANICAL ADVANTAGE	OUTPUT ANGULAR STROKE	TURNS PER 90°	DRIVE (IN)
42476	1088:1	272:1	90±20°	272	Ø1.180

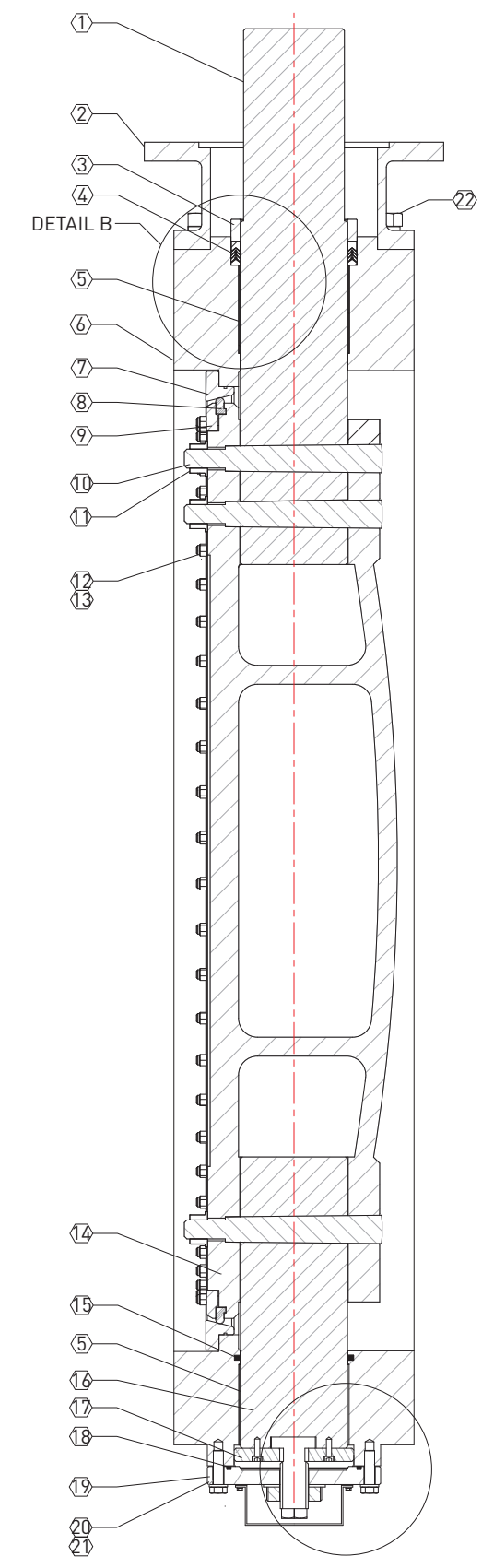
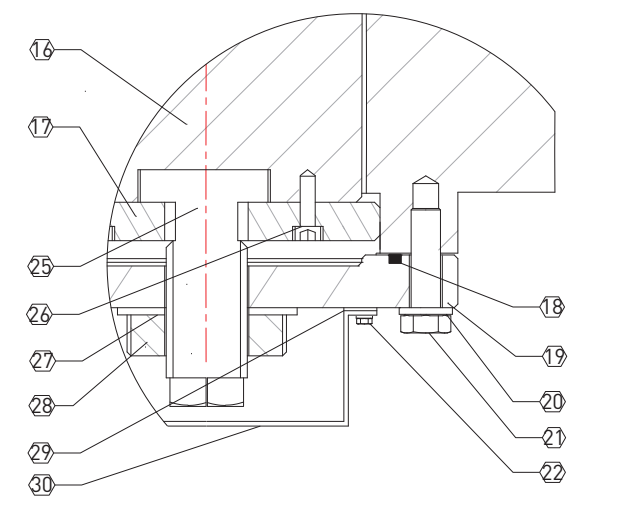
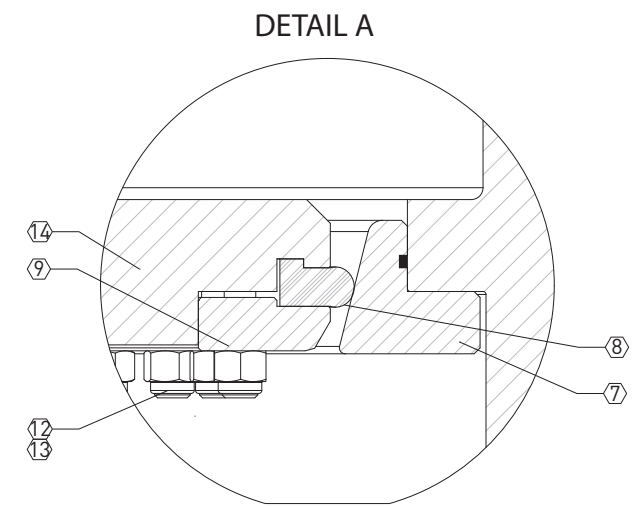
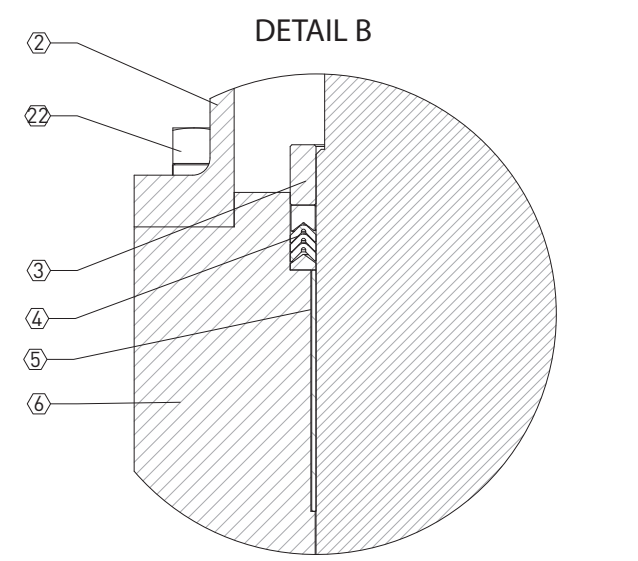

NO	NAME	MATERIAL	COUNT
1	UPPER STEM	ASTM A276 316	1
2	BONNET	ASTM A536 65-45-12	1
3	PACKING GLAND	ASTM A536 65-45-12	1
4	PACKING SET	EPDM	1
5	BUSHING	RPTFE	2
6	BODY	ASTM A536 65-45-12	1
7	SEAT RING	ASTM A276 316	1
8	SEAL	EPDM	1
9	SEAL RETAINING RING	ASTM A276 316	1
10	TAPER PIN	ASTM A276 316	3
11	HEX NUT	ASTM A276 316	3
12	STUD	ASTM F593 GROUP 2	60
13	NYLON LOCK-NUT	ASTM F593 GROUP 2	60
14	DISC	ASTM A536 65-45-12	1
15	O-RING	EPDM	1
16	LOWER STEM	ASTM A276 316	1
17	THRUST BUSHING	ASTM B584	1
18	O-RING	EPDM	1
19	LOWER COVER	ASTM A536 65-45-12	1
20	SPLIT LOCK WASHER	ASTM A276 316	8
21	HEX BOLT	ASTM F593 GROUP 2	8
22	HEX BOLT	ASTM F593 GROUP 2	6
23	HEX BOLT	ASTM F593 GROUP 2	4
24	HEX SOCKET BOLT	ASTM F593 GROUP 2	60
25	CENTERING BOLT	ASTM B584	1
26	HEX SOCKET BOLT	ASTM F593 GROUP 2	4
27	SEALING WASHER	PTFE	1
28	LOCK NUT	ASTM A276 316	1
29	SEAL	EPDM	1
30	PROTECTIVE COVER	ASTM A36	1

PROJECT: 60-INCH DOUBLE OFFSET REPLACABLE SEAT BUTTERFLY VALVE WITH VSI SERIES D WORM GEAR

DRAWING NUM. BFIII-60-DIDI-316316-D509WG1088M-121312

	SCALE	NTS	A3
	UNITS	INCHES	
	SHEET	2 OF 2	

DO NOT SCALE

PROPRIETARY AND CONFIDENTIAL THE INFORMATION CONTAINED IN THESE DRAWINGS IS THE SOLE PROPERTY OF VALVE SOLUTIONS INC. ANY REPRODUCTION IN PART OR AS A WHOLE WITHOUT THE WRITTEN PERMISSION OF VALVE SOLUTIONS INC. IS PROHIBITED.

TOLERANCES			
DECIMAL	ANGULAR		
.X	± .1	± .25°	
.XX	± .01		
.XXX	± .005		

	NAME	SIGNATURE	DATE	NOTE
DRAWN	JBH		12/12	
CHK'D	CJK	<i>[Signature]</i>	12/12	
REVISED	CJK		04/13	CHANGE TO VSI GEAR, ADD CENTERING BOLT

Valve Solutions, Inc.